

SG-28AHD-10SZ2-C

Low Light

- 1920(H)x1080(V) (AHD) Zoom Camera
- 1/3" Panasonic 2.1M CMOS Sensor
- Color: 0.05Lux@F1.8, B/W: 0.02Lux@F1.8, IR ON:0Lux@F1.8
- Optical 10X Zoom
- Push AF & Auto IRIS Zoom Lens
- Simultaneous Video Output: AHD / Composite BNC
- OSD Menu Control
- Powerful WDR & Anti-Headlight (HLC)
- Fog Reduction & 3D/2D Noise Reduction



Video	Video System	PAL / NTSC Selectable
	Image Sensor	1/3" Panasonic 2.1M CMOS Sensor
	Resolution	1920(H)x1080(V)
	Frame Rates	1920x1080P@25/30fps
	AHD Standards	AHD
	Minimum Illumination	Color: 0.05Lux@F1.8, B/W: 0.02Lux@F1.8, IR ON:0Lux@F1.8
	Wide Dynamic Range	120dB
	Digital Video Output	AHD 1080p
	Analog Video Output	CVBS (1.0Vp-p Composite, 75Ω)
	Audio	NA
	Mechanical IR Cut Filter	Automatically Switches (Switching Lux Level can be adjusted)
	IR LED ; Working Distance	30 units(6pcs High Power) ; 20~30m
Function	OSD Menu	OSD Control / CoC
	Title	TITLE (LOCATION)
	Digital Day&Night Mode	COLOR / B&W / AUTO / IR Sync
	Electronic Shutter	AUTO:1/25(30)~1/30, 000 Sec, Flickerless; MANUAL: 1/25(30), 1/50(60), 1/100(120), 1/240, 1/500, 1/1000, 1/2000, 1/4000, 1/8000, 1/16000, 1/30000 Sec
	Auto Gain Control	0~20 steps
	White Balance	ATW / AWB / PWB(Push Lock) / Manual
	WDR;BLC;HLC	HIGH (Max 90dB) / MIDDLE / LOW / OFF ; Program ; ON/OFF
	Flickerless	PAL 50Hz / NTSC 60Hz / OFF
	Fog Reduction	Auto/Manual/Off ; Level: High/Middle/Low
	Dynamic Noise Reduction	HIGH / MIDDLE / LOW / OFF
	Sense Up	ON (x2, x4, x8, x16, x32) / OFF
	Digital Image Stabilizer	NA
	Language	ENGLISH, JAPANESE, TRADITIONAL CHINESE, SIMPLIFIED CHINESE
	E-Zoom	8x
	Image Setting	SHARPNESS / MIRROR / FLIP
	Privacy Zone Mask	16 Zones Programmable
	Motion Detection	ON:sensitivity, programmable / OFF
General	Camera Control Interface	CoC
	Lens	10X Optical Zoom f5.0mm(Wide)~50mm(Tele), F1.8 to F3.0
	Angle of View	H:49.38° (Wide)~5.30° (Tele)
	Minimum Working Distance	1m
	Focusing System	Smart Zoom & Auto Focus
	Water Resistance	IP66
	Power Supply ; Consumption	12Vdc, PoC ; 3.36W
	Operation ; Storage Temp.	-10° C ~ 50° C ; -20° C ~ 60° C
	Operation ; Storage Humidity	Maximum: RH80% ; RH90%
	Dimensions	89(DIA) x 168(L)mm
	Net Weight	700g



Dimensions

Tol:±0.5 Unit:mm

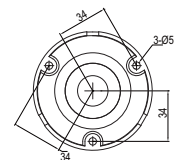
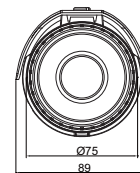
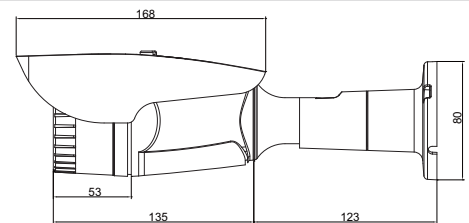

Bracket Options

Accessories